

# Strata Planters

Cabinet Planter and Park Planter Range

## User Manual



# Strata Planters

## User Manual



This manual remains the sole property of Dexion Commercial (New Zealand) Limited (Precision). The information contained within this manual is to be regarded as confidential and must not be disclosed to any third party.

Whilst the utmost care is taken to ensure the accuracy of the data and design details shown within, Dexion Commercial cannot, under any circumstances, be held liable for any injuries, expenses or loss which may, in any degree, be attributed to the use or adoption of such data and design details.

Any modification, repair, or alteration of the products described herein by a third party without written approval voids Dexion Commercial's warranty obligations.

© Copyright:

Dexion Commercial (New Zealand) Limited  
25 Peterkin Street  
Wingate  
Lower Hutt  
Wellington 5045

Ph: +64 4 9205400  
Fax: +64 4 9205402

Date of Issue: February 2011

Issue	Date Issued	Description
Issue 1	February 2011	Product Launch

# Strata Planters

## Table of Contents

<b>SECTION 1 PRODUCT INTRODUCTION .....</b>	<b>1</b>
STRATA PLANTERS .....	1
Strata Cabinet Planters.....	1
Strata Park.....	1
Components .....	2
Materials .....	2
PRODUCT PARAMETERS.....	3
<b>SECTION 2 STRATA CABINET PLANTERS .....</b>	<b>1</b>
STRATA CABINET PLANTERS .....	1
<b>SECTION 3 STRATA PARK .....</b>	<b>1</b>
STRATA PARK PLANTERS .....	1
<b>SECTION 4 SET UP &amp; MAINTENANCE .....</b>	<b>1</b>
GENERAL CARE .....	1
PLANTER DRESSING LIMITATIONS.....	1
TYPICAL INSTALLATION.....	2
WATERING INSTRUCTIONS .....	2
RELEVELLING FLOOR MOUNTED PLANTERS.....	3
OPTIONAL EXTRAS.....	4

## SECTION 1

# PRODUCT INTRODUCTION

### STRATA PLANTERS

Precision Strata Planters are a premium range of planter boxes.

These planter boxes are provided complete with moulded ABS pot liners that provide both strong support and moisture protection.

#### Strata Cabinet Planters

Strata Cabinet Planters are a range of 4 standard planter boxes that are designed to be used on top of Strata (or Maxim) tambour door cabinets.



#### Strata Park

Strata Park planter is a freeform version that can be used in a variety of configurations, to facilitate the integration of plants into the office environment.

Strata Park Planters feature adjustable feet as standard. Alternatively castors may be used on smaller units to provide mobility.

A range of accessories is also possible including seat cushions, LPL MDF and steel infill top panels.



## Components

Strata Planters are available in 2 variations, Strata Cabinet Planters and Strata Park. Each version is constructed in a similar manner, and made up of similar style components as detailed in the diagram below.

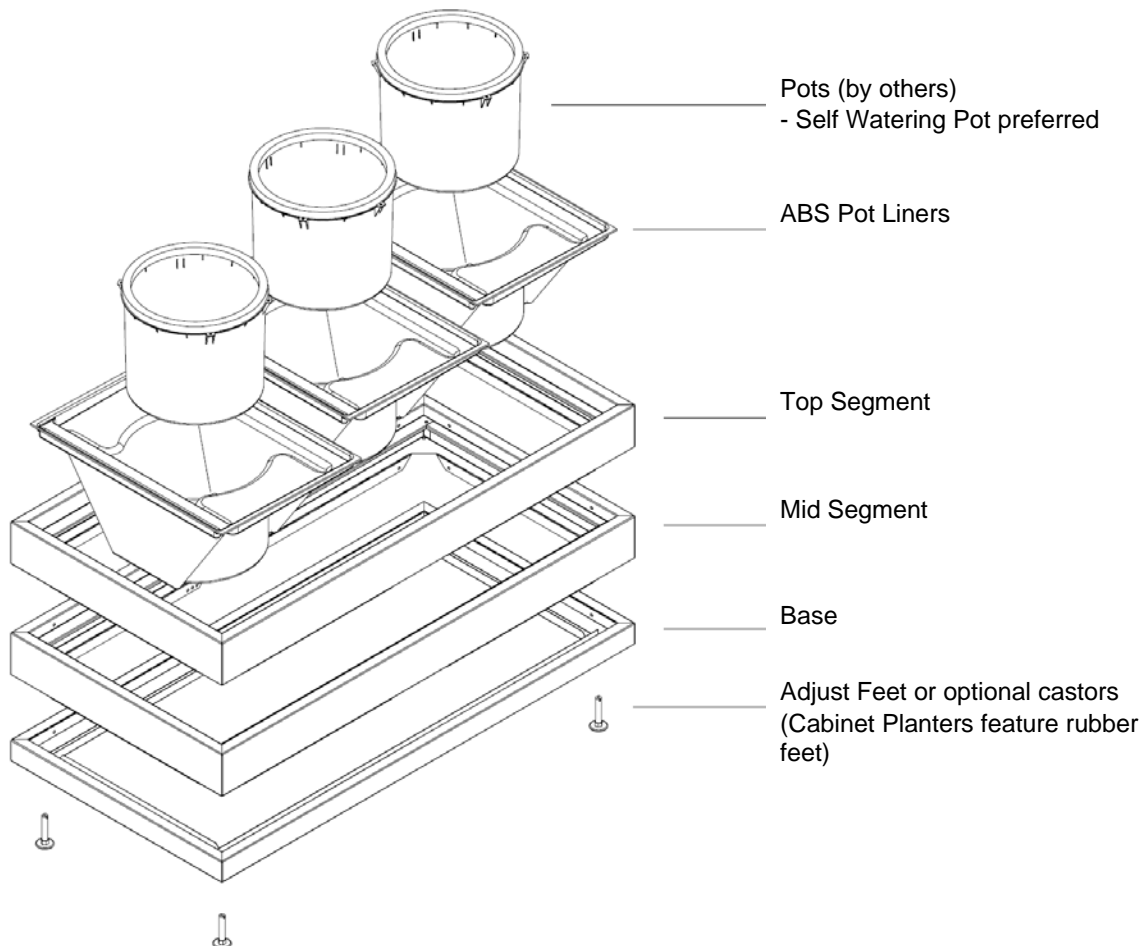

## Materials

Components of the planter products are typically produced from the following materials and finishes

Material	Base and Segments:	High strength zinc coated steel
	Pot Liners:	Formed ABS
Finish	Base and Segments:	Powder Coated
	Pot Liners:	Black

## PRODUCT PARAMETERS

Strata Planters are designed to operate within the following standard parameters.

### Floor

The floor should be of solid construction designed to accept loads imposed by the product.

### Loads

Individual loads should be stable and self supporting, with a maximum unit weight within the safe working recommendations.

Each planter liner is able to withhold a maximum of 25kgs of mass. This is a total combined weight of plant, pot, dressing material and any additional materials that are housed within the confines of the planter liner.

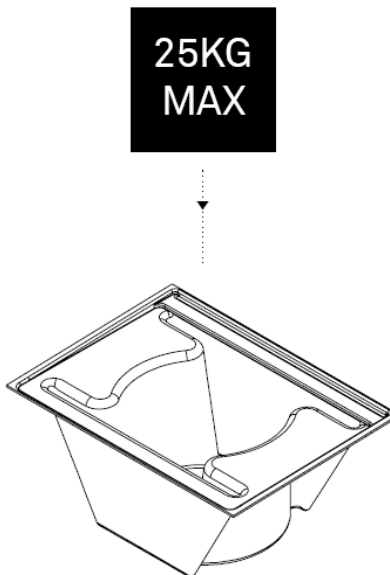

### Operating Conditions

Components and load data are based on dry internal applications.

### Temperature

+3°C to +40°C.

### Note:

*For applications that require operating parameters that are outside those indicated above, please contact Dexion Commercial for technical guidance on your particular application.*

## SECTION 2

# STRATA CABINET PLANTERS

### STRATA CABINET PLANTERS

Strata Cabinet Planters are designed to be used on top of Smartstore® Generation 2 tambour door cabinets. These planter boxes are provided complete with moulded ABS pot liners that provide both strong support and moisture protection.

Strata Cabinet Planters are designed to accept 200mm (8") pots as standard.

Strata Cabinet Planters are available in the following dimensions:

- Widths: 900mm and 1200mm.
- Height: 200mm.
- Depth: 470mm deep to match the depth of the cabinets

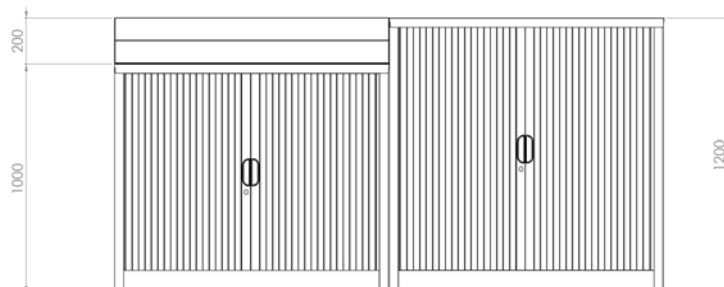
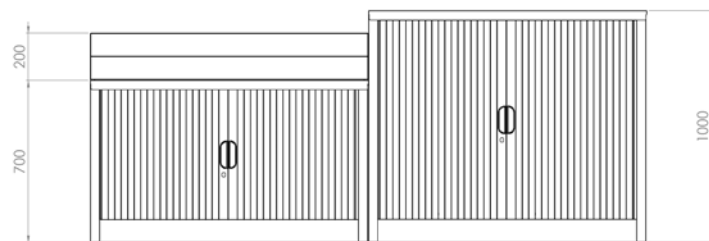

Note that the combined height of cabinet and planter should not exceed 1400mm

## SECTION 3

# STRATA PARK

### STRATA PARK PLANTERS

Strata Park planter units are the freeform version that can be used in a variety of configurations, to facilitate the integration of plants into the office environment.



These planter boxes are also provided complete with moulded ABS pot liners that provide both strong support for the potted plants and moisture protection.

Strata Park planters feature adjustable feet as standard, or alternatively castors can be fitted to smaller units to provide mobility.

A range of accessories is also possible including seat cushions and steel infill tops are available.

Note that Strata Park units are 450mm deep to facilitate modular configuration of the units.

Strata Park is designed to use 200mm (8") pot liners, however can accommodate 300mm (12") liners in special circumstances. Please see following or contact Precision for further information.



## SECTION 4

### SET UP & MAINTENANCE

#### GENERAL CARE

Strata Planter and Park units should have a periodic clean out and a dusting using a soft cloth and a non-abrasive, non-solvent based cleaning agent. Whilst cleaning, particular attention should be given to ensuring there is no water build up in the planter liners

#### PLANTER DRESSING LIMITATIONS

Areas indicated by the green shade shows maximum clearance for dressing pebbles and like materials. Dressing materials should not overflow the extents of the planter box carcass.

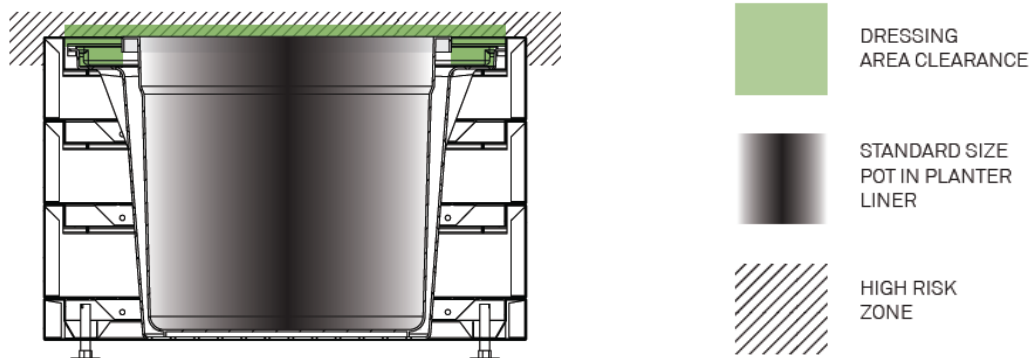

For a list of suitable dressing materials for planter units, consult a plants expert or contact us so we can forward your query on to suitable professionals.

**IMPORTANT NOTE** - Each planter liner is able to withhold a maximum of 25kgs of mass. This is a total combined weight of plant, pot, dressing material and any additional materials that are housed within the confines of the planter liner.

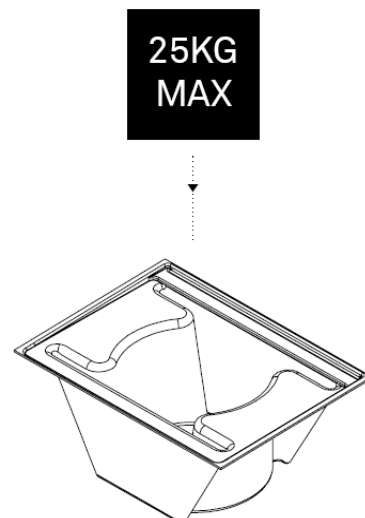

## TYPICAL INSTALLATION

Dressing pebbles are shown placed within the borders of the carcass. Plants are positioned central to each pot. Please note, dressing materials should not overflow onto the border of the planter box.

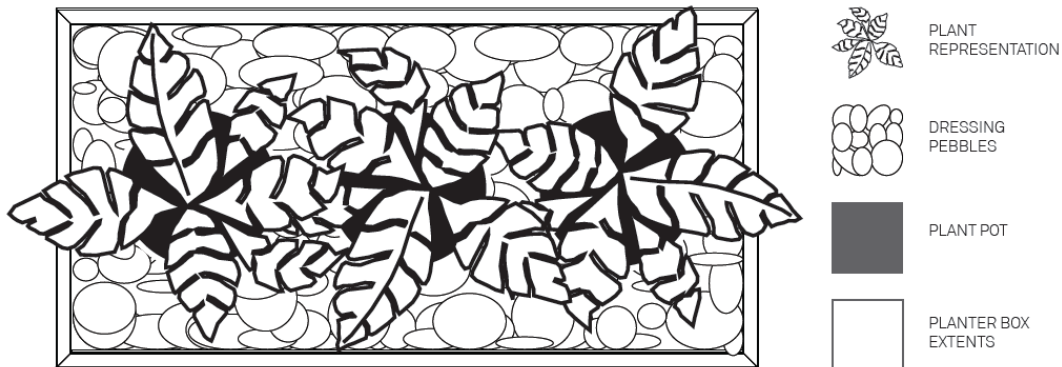

## WATERING INSTRUCTIONS

For proper watering and maintenance practice, the diagram below indicates the areas where watering should occur.

The darker colour represents the best possible place to water your plant. The lighter colour represents areas that you can still water your plant from. For safety and issues surrounding over flowing, please water your plants in the areas indicated by the darker colour. It is important that during the life of the plant within an indoor environment that watering does not occur in the areas indicated by hatching. Water your plants in the coloured areas to avoid damage to personal items and/or floor.

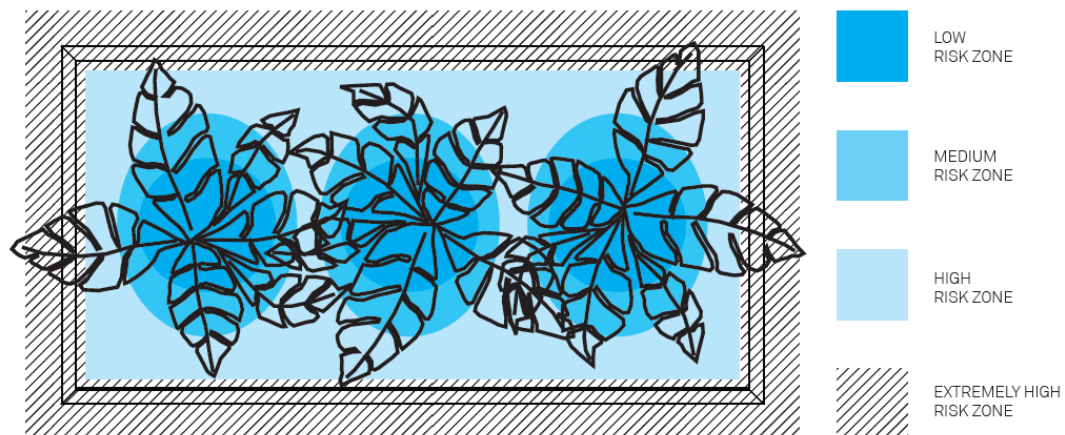

An easy self-watering pot is available and perfectly works with our planter liners. These pots are easy to maintain and integrated within the pot is its own water reservoir. These self-watering pots are your safest option to have complete peace-of-mind from situations that may arise due to potential overwatering. For more information contact your Precision representative.

## RE-LEVELLING FLOOR MOUNTED PLANTERS

When floor mounted planter units are installed, they are placed in their desired location and are levelled. If the unit is installed on thick carpet that has compressed, or if the unit is moved, the unit may need to be re-levelled.

Each unit/module has 4 adjustable levelling feet that can be accessed by lifting the planter liners located in the body of the unit. If the unit requires re-levelling after plants are fitted, it is advised to remove the liners with the plants and dressing to access adjustable feet from inside. Alternatively, adjustable feet can be adjusted from underneath although this is typically more difficult and time consuming (see diagram).

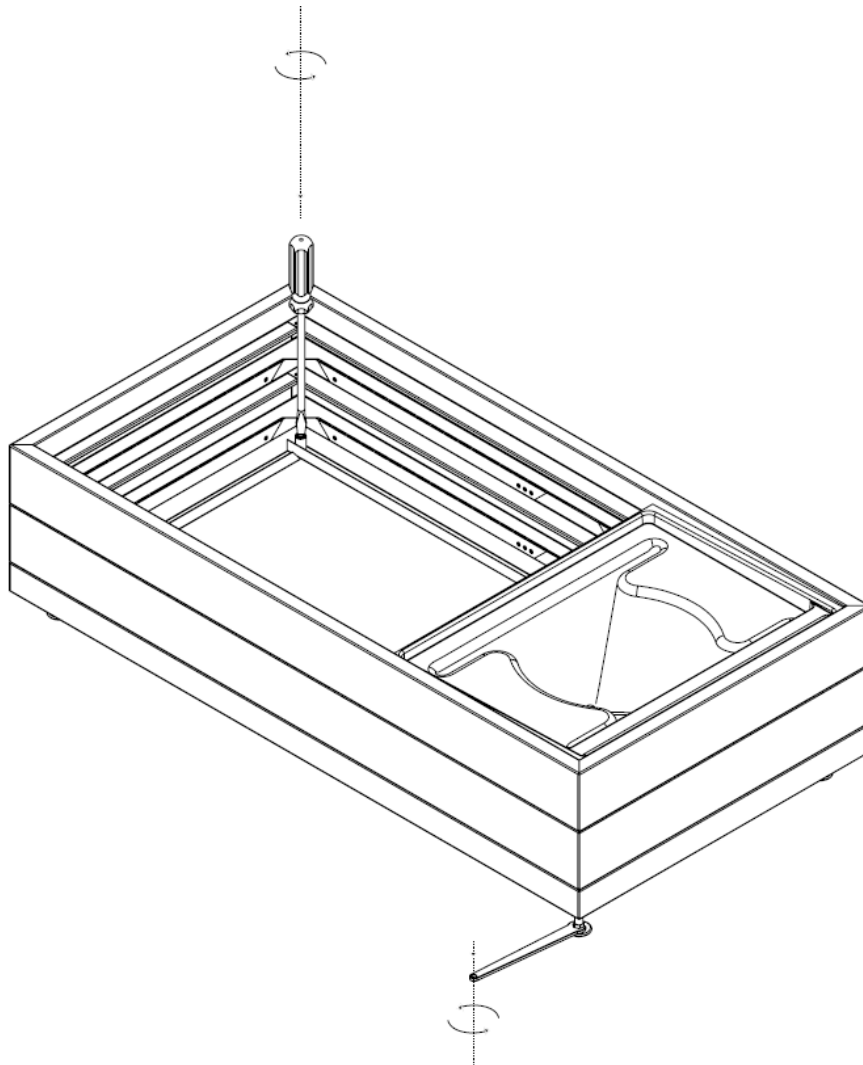

## OPTIONAL EXTRAS

Seat cushions and LPL MDF or steel infill panels are available for floor mounted planters as optional extras if required.

Seat cushions provide a comfortable foam filled fabric covered bench style seat up to 900mm long, while LPL MDF or steel infill panels provide a clean need top surface that sits flush with the top of the planter carcass.

